

PACKING LIST



1



User Manual

2



3



4



5

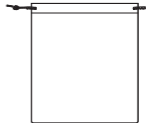

6

PRODUCT OVERVIEW

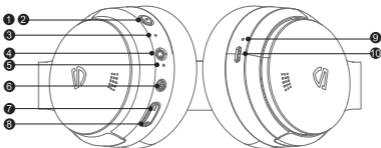

1. ANC Switch
2. ANC Switch Indicator Light
3. MIC
4. AUX Interface
5. LED Indicator Light

6. Power Switch
7. Volume Down
8. Volume Up
9. Charge Indicator Light
10. USB-C Charge Interface

POWER ON/OFF, ANC SWITCH

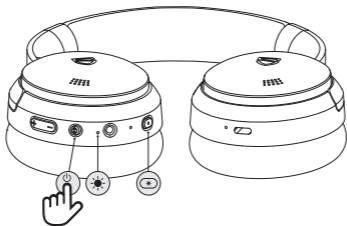

Power On: Long press the power button 3s, the blue LED light will be steady on 2s and then go off after flash slowly once.

Power Off: Long press the power button for about 4s, the red LED light will up 2s and then go out.

ANC On: Short press the ANC button once, and the ANC blue indicator lights up.

ANC Off: Short press the ANC button once, and the ANC blue indicator lights goes off.

Note: In order to avoid the failure of the power switch to the greatest extent, it is recommended to wait for 2-3 seconds to restart again after turn off the headphone.

BLUETOOTH PARING

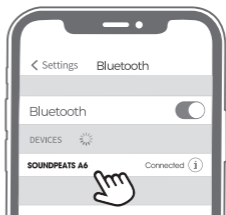
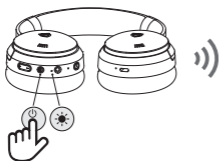

1. Long press the power button 3s in the power-off state to hear power on. After 5s, hear paring enter the pairing mode, and the indicator light flashes alternately in red and blue.
2. After the first connection, the headset will automatically connect back to the last connected device when it is turned on;
3. If you want to change the device or enter forced pairing, long press the power button 5s in the power off state;
4. Reset: Under the power-on and non-talking state, long-press the power button and the sound plus button 5s at the same time, until the purple light comes on 2s and then goes out completely, hearing two "beep", clear the pairing records and then enter the pairing state.

CONTROL

| Mode | Function | Operation Methods |
|----------------|--------------------------|---|
| Bluetooth Mode | Play/Pause | Short press the power button once |
| | Previous Track | Long press “-” button once |
| | Next Track | Long press “+” button once |
| | Volume Up | Short press “+” button once |
| | Volume Down | Short press “-” button once |
| | Activate Voice Assistant | Long press the power button for 2s and then release |
| Calling Mode | Answer/Hang up a call | Short press the power button once |
| | Reject a Call | Long press the power button 2s |
| | Redial Last Number | Double-click the power button to redial the last call |
| | Voice Transfer | In the call state, long press the power key 2s and then the call sound is switched between the headset and the mobile phone |

AUX-IN

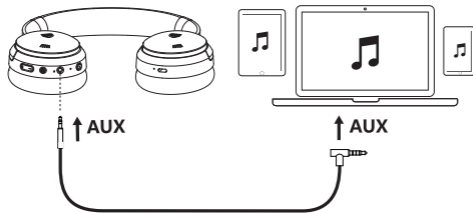

1. Inserting the audio cable will automatically switch to AUX mode. Long press the power key 3s and then short press the ANC key to enable the ANC function in AUX mode.
2. In AUX mode, the functions of increasing/decreasing volume, pausing play, previous /next track on headphones will be invalid, which needs to be operated through the mobile terminal and corresponding APP.

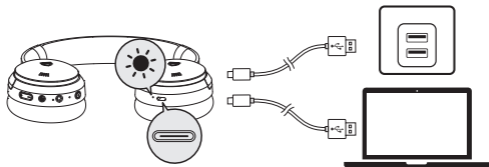
CHARGE

The red light is always on when charging, and off when fully charged.

WARRANTY REGULATIONS

We begin to guarantee the headset for a period of 12 months when the original purchaser purchases the product, and the warranty is limited to manufacturing defects.

✉ **support@soundpeatsaudio.com**

🌐 **www.soundpeatsaudio.com**

Please scan the QR code to view the detailed version of the manual in PDF format.



<https://soundpeatsaudio.com/downloads/>

FCC STATEMENT

This equipment has been tested and found to comply with the limits for a Class B digital device, pursuant to Part 15 of the FCC Rules. These limits are designed to provide reasonable protection against harmful interference in a residential installation. This equipment generates uses and can radiate radio frequency energy and, if not installed and used in accordance with the instructions, may cause harmful interference to radio communications. However, there is no guarantee that interference will not occur in a particular installation. If this equipment does cause harmful interference to radio or television reception, which can be determined by turning the equipment off and on, the user is encouraged to try to correct the interference by one or more of the following measures:

- Reorient or relocate the receiving antenna.
- Increase the separation between the equipment and receiver.
- Connect the equipment into an outlet on a circuit different from that to which the receiver is connected.
- Consult the dealer or an experienced radio/TV technician for help.

This device complies with part 15 of the FCC Rules. Operation is subject to the following two conditions:

(1) This device may not cause harmful interference, and (2) this device must accept any interference received, including interference that may cause undesired operation.

Changes or modifications not expressly approved by the party responsible for compliance could void the user's authority to operate the equipment.